

SIRKUM  
POLARIS

NUUA



# KULOVALKEA

SIRKUM POLARIS & NUUA COMPANY





# KULOVALKEA

SIRKUM POLARIS & NUUA COMPANY

Kulovalkea is an old-fashioned Finnish word that means a fast-spreading forest fire. This metaphor invites the audience to witness something wistfully beautiful and make room for something new. The performance offers ethereal atmospheres and dreamlike stage images, like moving paintings, and a space for creative movements that take the viewer into a curious state. Through cooperation and confrontation, things that seem ordinary become unexpected and twisted.

Truth is not always what reality conveys, but more what is drawn from our subconscious, dreams, and visions buried deep in our psyche. Kulovalkea offers a series of images that fuel ingenuity and defy rationality. With the power of eight circus artists, we create a virtuoso and absurd journey to the borderlands of consciousness.

Kulovalkea has been produced together with Sirkum Polaris and Company Nuua. The performers of Sirkum Polaris, who all graduated from different circus schools around the world, have gathered with Nuua's artistic team to create one of Finland's biggest touring contemporary circus projects on a theatre stage.

We aim to renew the working methods and content of larger group productions. We are bringing new influences to Finland with a work group whose members have lived, studied, and worked worldwide.

Duration: 70min



## SIRKUM POLARIS

Sirkum Polaris was founded in 2015 by 10 circus artists who grew up together in Sorin Sirkus in Tampere, Finland. From there they spread out to different circus schools around Europe (ESAC, Codarts, DOCH, Academie Fratellini, ENC) to further develop their skills and ideas. Now they have once again returned to north to perform and create together.

Sirkum Polaris aspires to combine different views acquired in various circus schools to create unique contemporary circus performances. The variety of circus disciplines and personalities in the group open up possibilities to push Finnish contemporary circus to new and uncharted territories.

[www.sirkumpolaris.com](http://www.sirkumpolaris.com)

## NUUA COMPANY

Founded in 2012, Nuua Company is a Finnish new-generation contemporary circus and visual theater group that redeemed its place in the international field of contemporary circus with its experimental works.

On its ten-year journey, Nuua Company has been selected for a Circus next program, Nuua's award-winning performances have received notable mentions from critics and books about the contemporary circus, and the performances have been touring in 20 countries.

Nuua renews juggling as object theater, concepts connecting body and object movements, and explores circus techniques as tools of expression. Depending on the viewer's personal experiences, our multilayered performances open up to everyone differently. We are awakening the emotions, imagination, and sensitivity into an empowered state more receptive to new dreamlike experiences.

[www.nuua.company](http://www.nuua.company)



# SCHEDULE

PREMIERE 5-6.10,2023 @ STOA, Helsinki

2017

- September 2017, Cirko-center, Helsinki, 2 weeks

2018

- February 2018, Cirkör Lab, Stockholm, 2 weeks
- June 2018, Subtopia, Stockholm, 2 weeks
- July 2018, Sorin Sirkus, Tampere, 2 weeks
- October 2018, Circa, Auch, pitching of the project
- November 2018, Latitude 50, Belgium, 2 weeks

2019

- January 2019, Cirko-center, Helsinki, 2 weeks
- August 2019, Sorin Sirkus, Tampere, 1 week
- September 2019, Circa, Auch, France, 2 weeks

2020

- February/March 2020, ESAC & La Roseraie, Brussels 2 weeks
- August 2020, Dynamo, Odense, Denmark, 2 weeks
- August 2020, Dynamo, PRE-PREMIERE

 **TEASER VIDEO**

# CREDITS

## DIRECTOR

Olli Vuorinen

## PERFORMERS

Rosa-Maria Autio, Merri Heikkilä, Valpuri Kaarninen, Nelli Kujansivu, Liisa Näykki, Maria Peltola, Onni Toivonen, Petteri Savikorpi, Pinja Seppälä, Juho Yrjölä, Jaimee Allen (11 artists in creation, 8 on stage)

## MUSIC/SOUND DESIGN

Katri Salmenoja

## LIGHT DESIGN

Teo Lanerva

## PRODUCTION

Sirkum Polaris & Nuua Company

## SUPPORT

Taike: Arts Promotion Centre of Finland

Nordic Culture Point  
Subtopia

## RESIDENCIES

Cirko Center in Helsinki

Cirkör Lab in Stockholm

Suptopia in Stockholm

Sorin Sirkus in Tampere

Latitude 50 in MARCHIN

Circa in Auch

ESAC in Brussels

La Roseraie in Brussels

Dynamo in Odense



# TECHNICAL SETUP

PREMILINARY

## 10 people on tour

8 artists, 1 technician, 1 director

We require a black dance marley

Dance floor is preferred.

black box with a backdrop and wings.

## STAGE SIZE

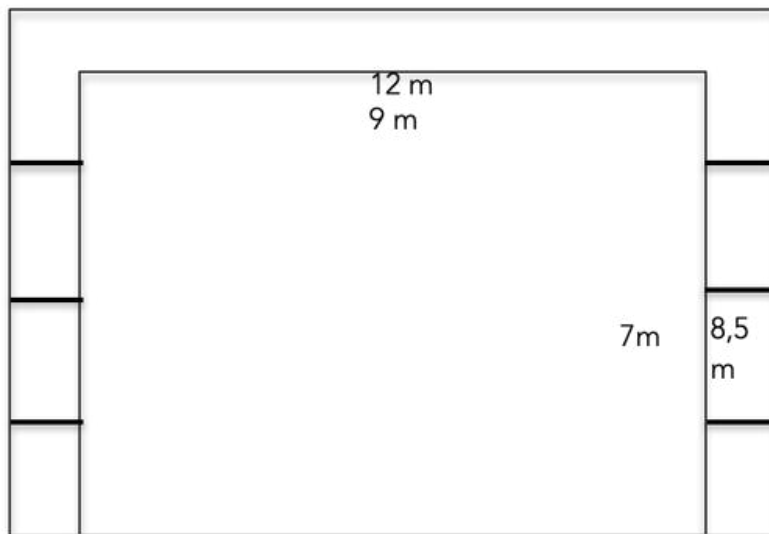

### On stage minimum:

Width: 9 m

Depth: 7 m

Height: 7 m

### Including wings/ backdrop:

Width: 12 m

Depth: 8,5 m

Height: 7 m

3 curtains to go on stage  
on both sides

## ATTACHMENT POINTS

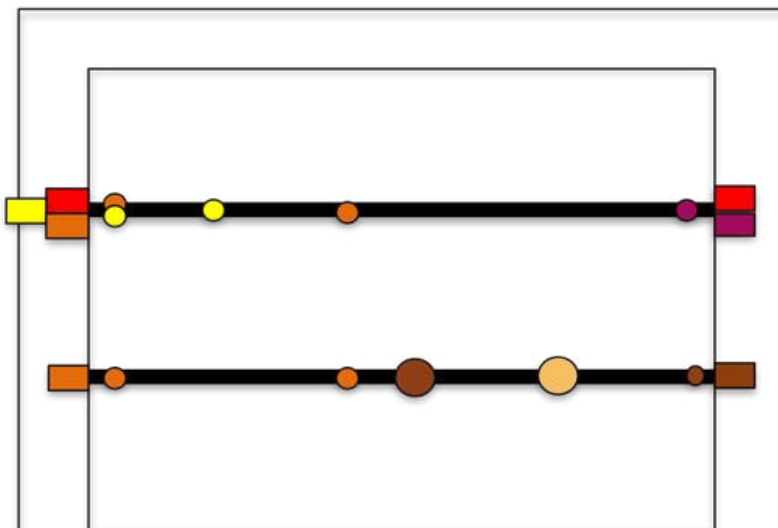

### Ceiling:

- Fixed single point group trapeze WLL 1200 kg
- Fixed single point rope
- Pulley system microphone
- Pulley system boxing bag
- Quick release trapeze

### Floor:

- Tight wire WLL 2000 kg
- Trapeze point WLL 400 kg
- Pulley point microphone
- Pulley point boxing bag
- Quick release point

N.B. Tight wire could be rigged anywhere in space that has enough strength to hold it. If not possible to rig a wire the performance can be also executed with an alternative part.



# CONTACTS

Sirkum Polaris  
sirkum.polaris@gmail.com,  
+358407708896 (Valpuri  
Kaarninen)

Nuua Company  
olli@nuua.compaany  
+358500435286 (Olli Vuorinen)  
www.nuua.company